

1 Atornillar guía superior a marco y contramarco previa introducción de los frenos de guía.

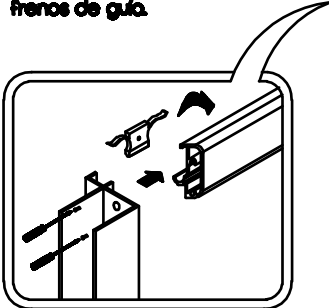

2 Colocar expansores en los marcos, señalar taladros y atornillar mampara a ambas paredes.

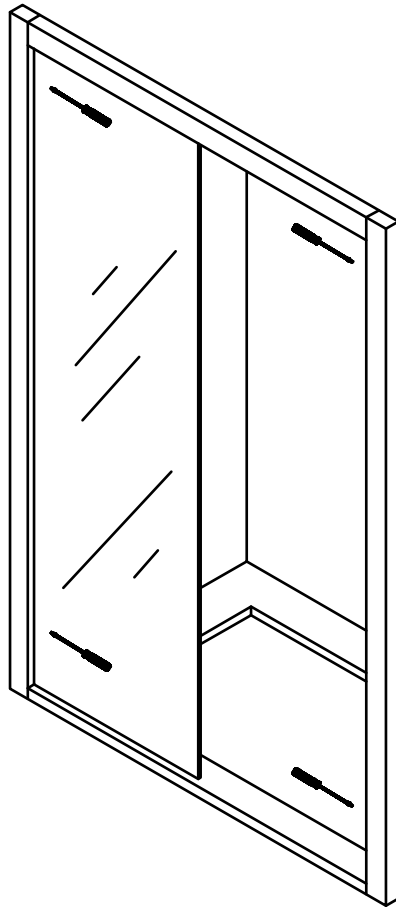

3 Señalar, taladrar y atornillar topes cogida fijo a guías.

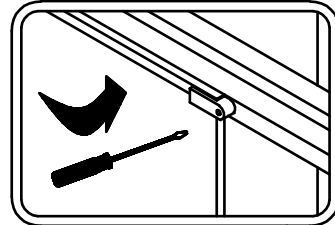

4 Colocar guíador inferior.

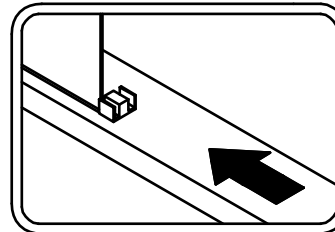

5 Colocar, gomas de cruce, vierteaguas, iman de la hoja, posteriormente colocar rodamientos en la parte superior del vidrio, colgar la hoja y antivuelco.

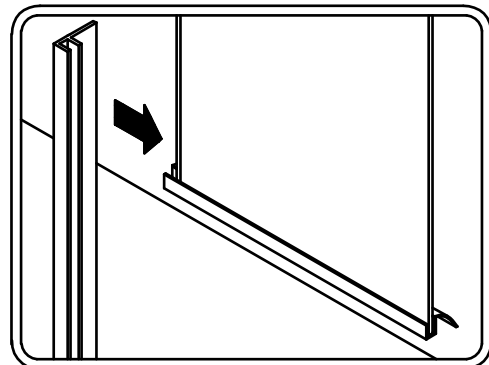
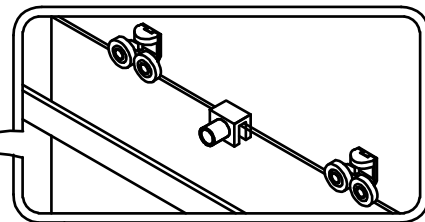
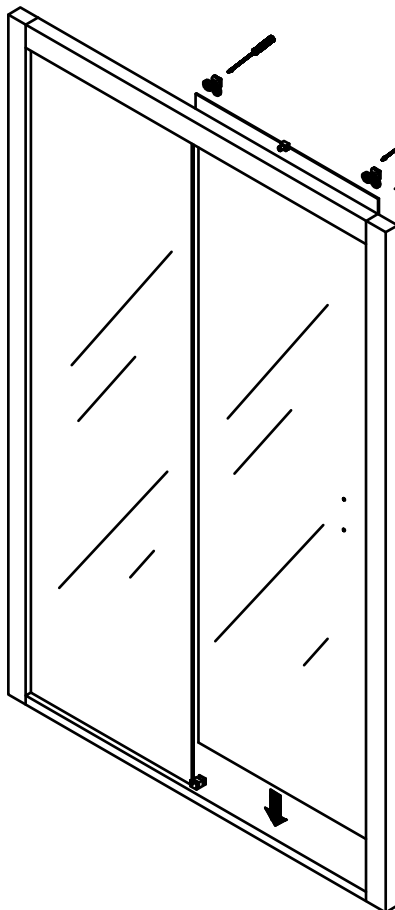
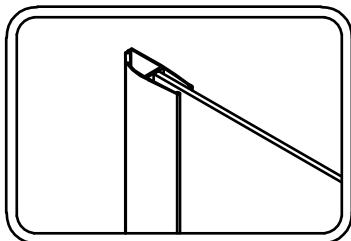

6

Graduamos la hoja mediante los tornillos de regulación de los rodamientos y colocamos el tirador.

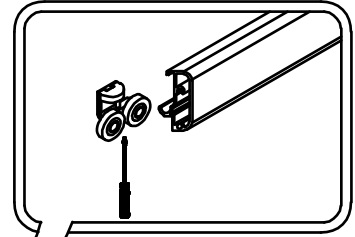

7

Colocamos embellecedor inferior
Sellado del contorno de la
mampara y colocación de
topes superiores.

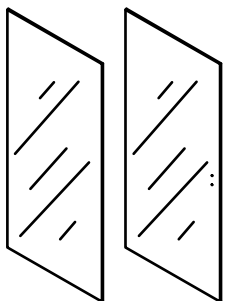
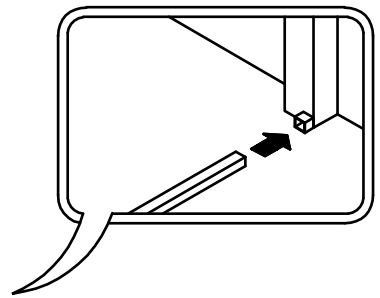
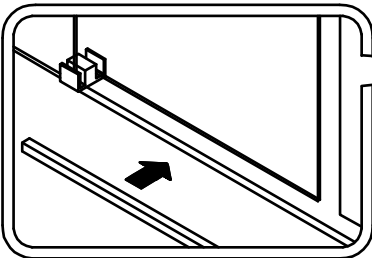
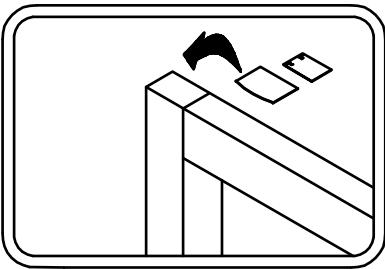

1x vidrio hoja fja

1x vidrio hoja
corredera



2x rodamientos de
acero inoxidable

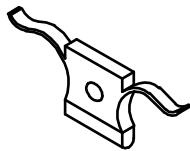

1x freno

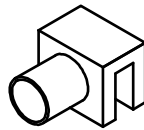

1x antivuelco

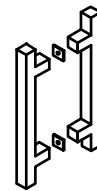

1x tirador

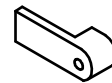

1x cogidos fijo

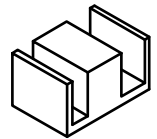

1x pino guía interior

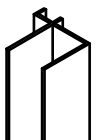

1x contramarco

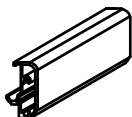

1x guía superior



1x marco lateral

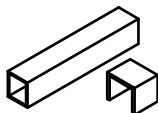

1x perfil bajo + tapa



2x gomas cruce



1x goma
verticogua

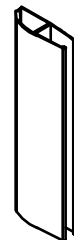

1x iman cierre



2x juegos
topes superiores