

1 Atornillar guía superior a marco previo introducción de los frenos de guía.

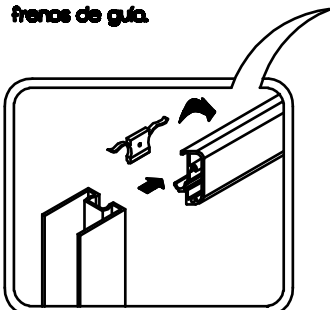

2 Colocar expansores en los marcos, señalar taladros y atornillar mampara a ambas paredes.

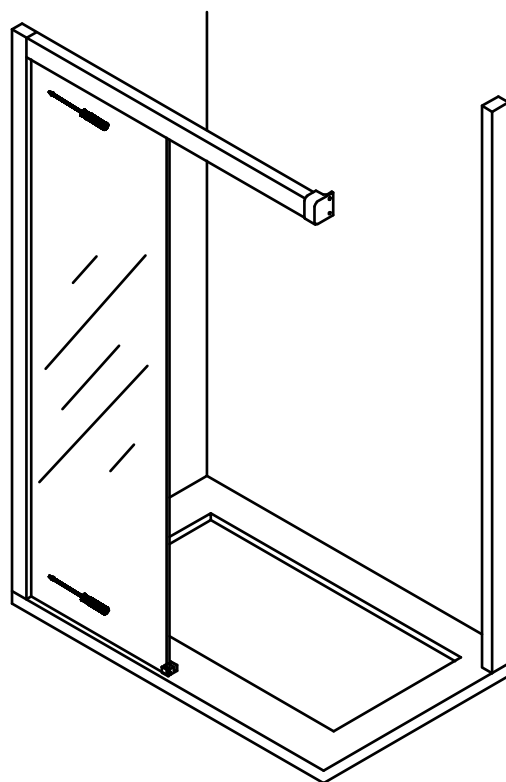

3 Señalar, taladrar y atornillar topes cogida fijo a guías.

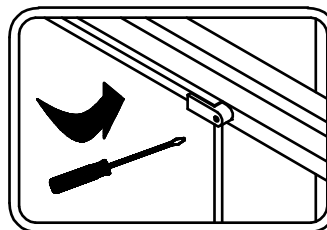

4 Colocar guíador inferior.

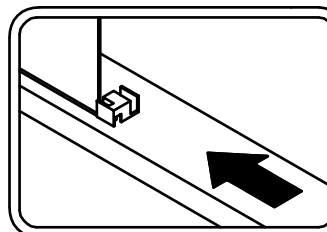

5 Atornillar fijo lateral a pared, luego sujetarlo a guía superior mediante pieza de cogida fijo lateral.

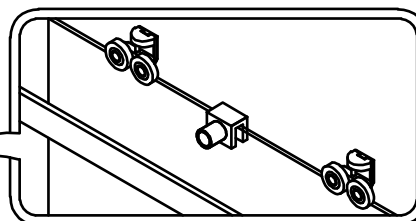

6 Colocar gomas de cruce y vierteaguasiman de la hoja, posteriormente colocar rodamientos en la parte superior del vidrio, colgar la hoja y antivuelco.

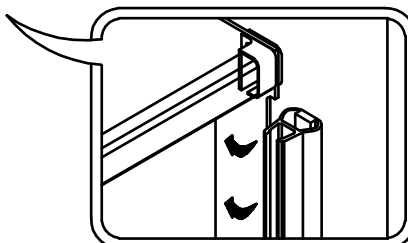
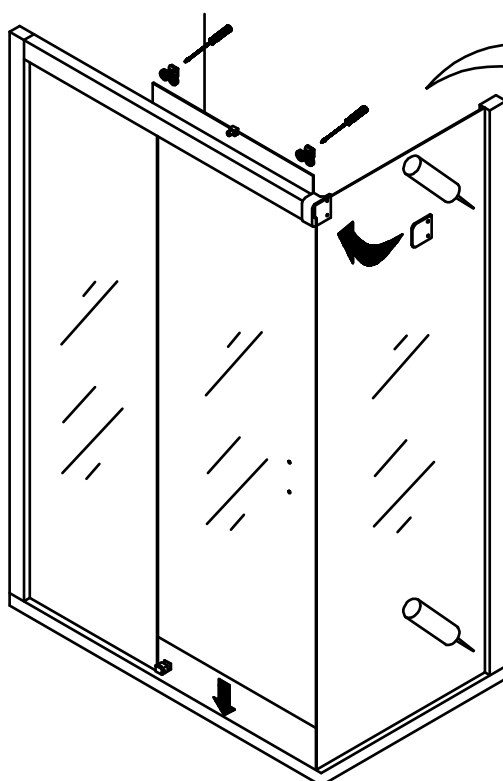
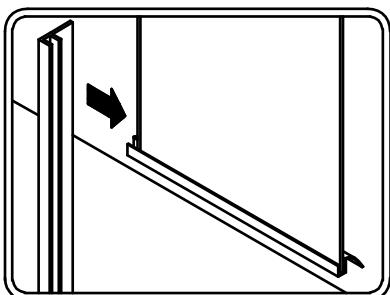

7

Graduamos la hoja mediante los tornillos de regulación de los rodamientos y colocamos el tirador. Colocar iman adhesivo en lateral.

8

Colocamos embellecedor inferior
Sellado del contorno de la mampara y colocación de tapas superiores.

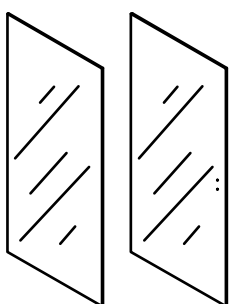
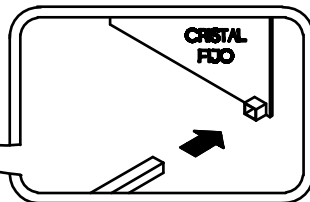
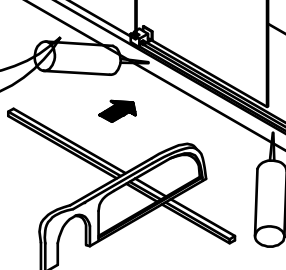
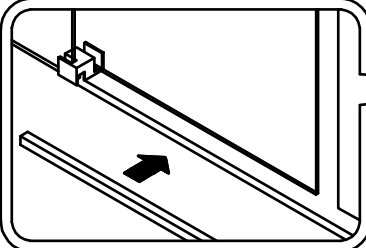
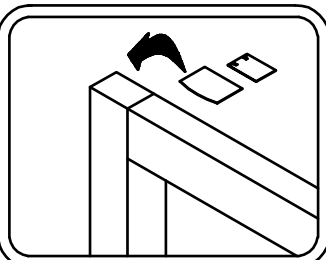
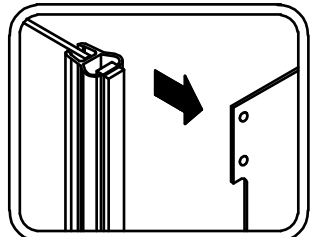
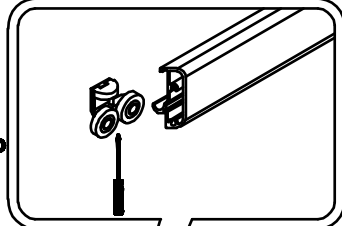

2x vidrio hoja fija
1x vidrio hoja corredera

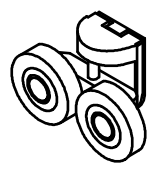

2x rodamientos de acero inoxidable

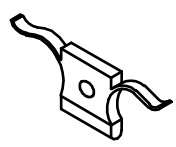

1x freno

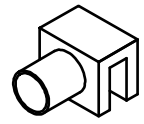

1x antivuelco

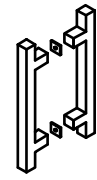

1x tirador

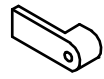

1x cogidos fijo

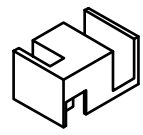

1x pino guía interior

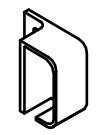

1x cogido a pared

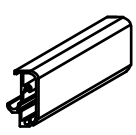

1x guía superior

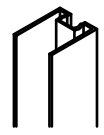

2x marco lateral

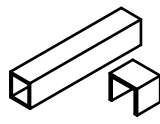

1x perfil bajo + tapa

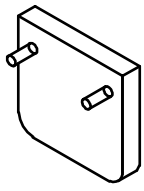

1x pieza cogido fijo lateral

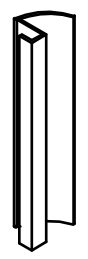

1x goma verticales



2x goma cruce

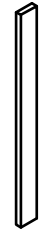

1x iman adhesivo



1x iman claro

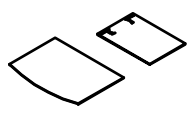

2x juegos tapas superiores