

1 Atornillar guía superior a marco y contramarco previa introducción de los frenos de guía.

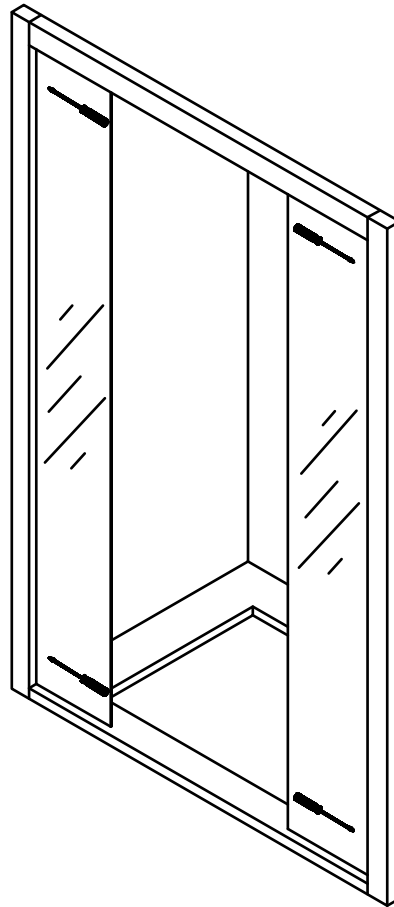

2 Colocar expansores en los marcos, señalar taladros y atornillar mampara a ambas paredes.



3 Señalar, taladrar y atornillar topes cogido fijo a guías.

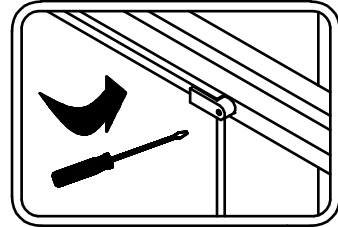

4 Colocar guías inferiores.

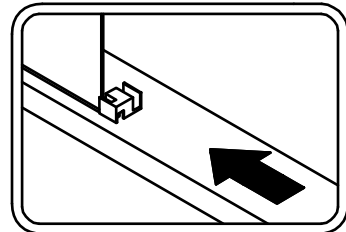

5 Colocar gomas de cruces, vierteaguas, iman de la hoja, posteriormente colocar rodamientos en la parte superior del vidrio, colgar la hoja y antivuelcos.

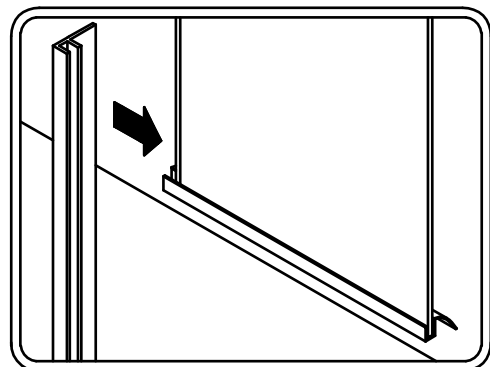
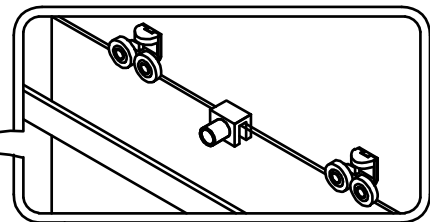
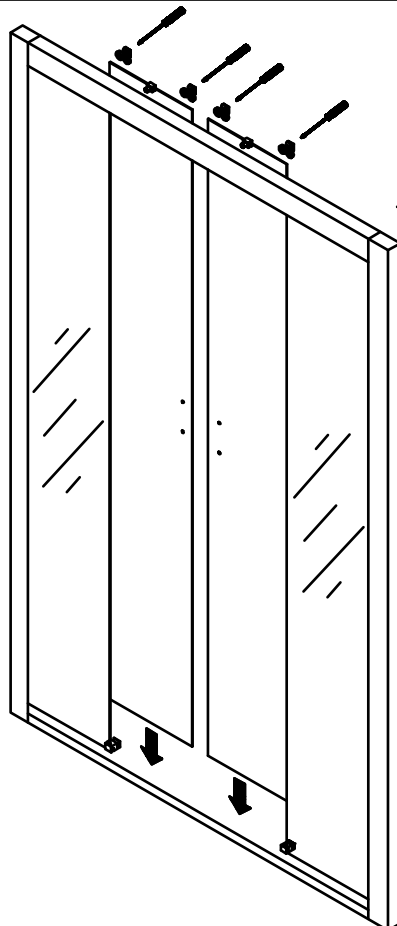
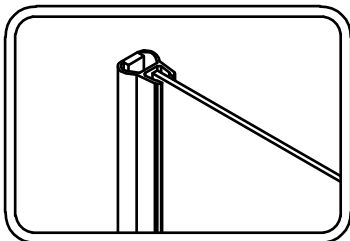

6
 Graduamos la hoja mediante los tornillos de regulación de los rodamientos y colocamos el tirador.

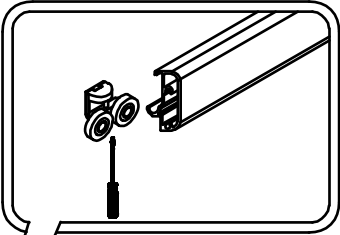

7
 Colocamos embellecedor inferior
 Sellado del contorno de la
 mampara y colocación de
 topes superiores.

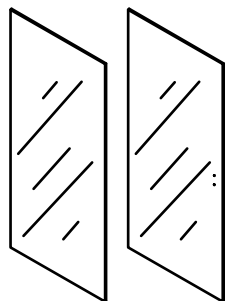
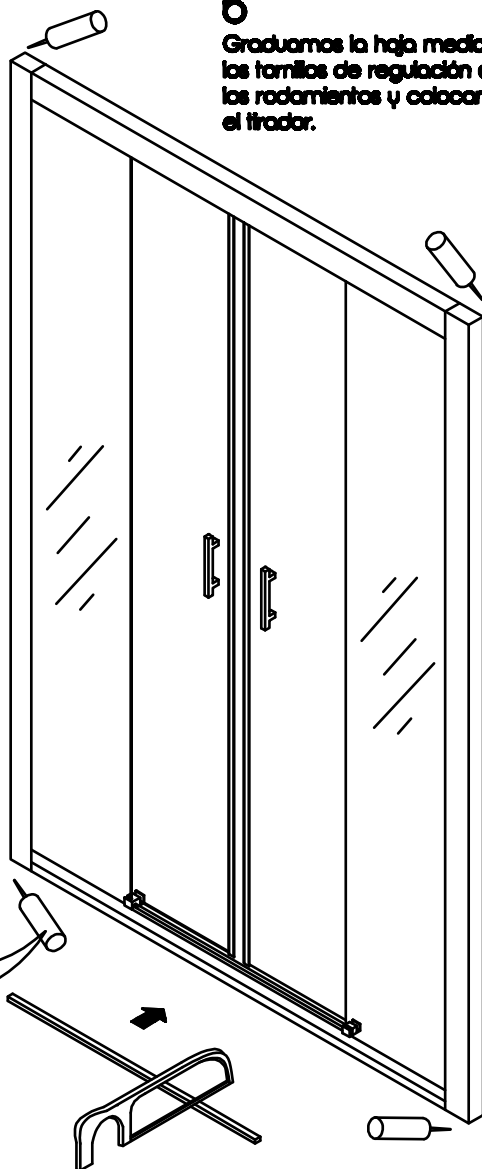
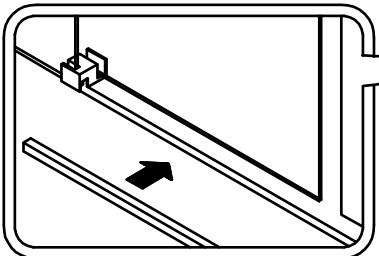
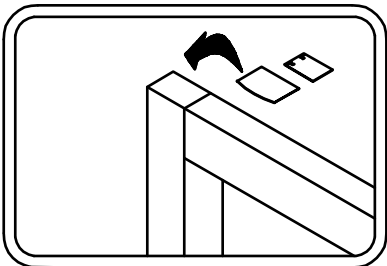

2 x vidrio hoja fija
 2 x vidrio hoja corredera

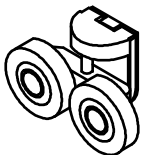

4 x rodamientos de acero inoxidable

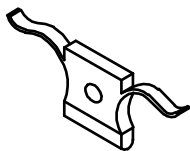

4 x freno

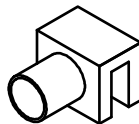

2 x antivuelco

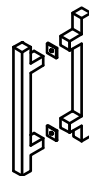

2 x tirador

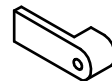

2 x cogidos fijo

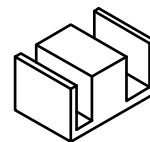

2 x pista guía interior

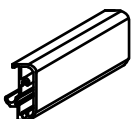

1 x guía superior

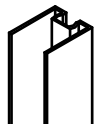

2 x marco lateral

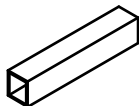

1 x perfil bajo

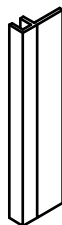

4 x gomas cruce



2 x goma variegada



2 x inlay claro

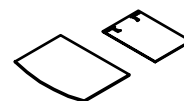

2 x juegos topes superiores