

1 Atornillar guía superior a marco previa introducción de los frenos de guía y unir mediante el codo superior.

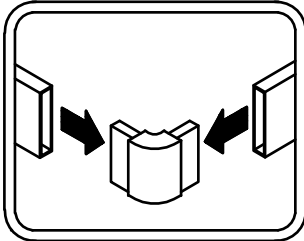

2 Colocar expansores en los marcos, señalar taladros y atornillar mampara a ambas paredes.

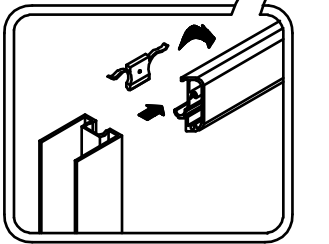

3 Señalar, taladrar y atornillar topes cogido fijo a guías.

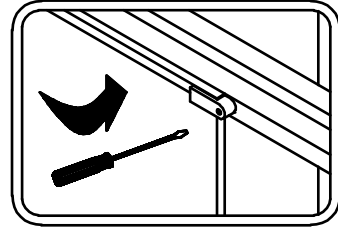

4 Colocar guías inferiores

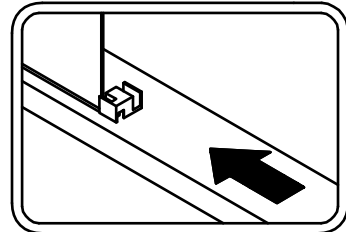

5 Colocar gomas de cruce y vierteaguas, lman de la hoja, posteriormente colocar rodamientos en la parte superior del vidrio, colgar los hajos y antivuelcos.

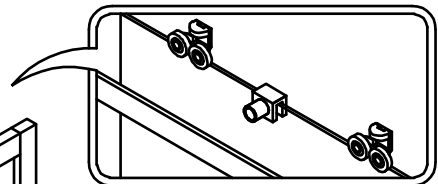
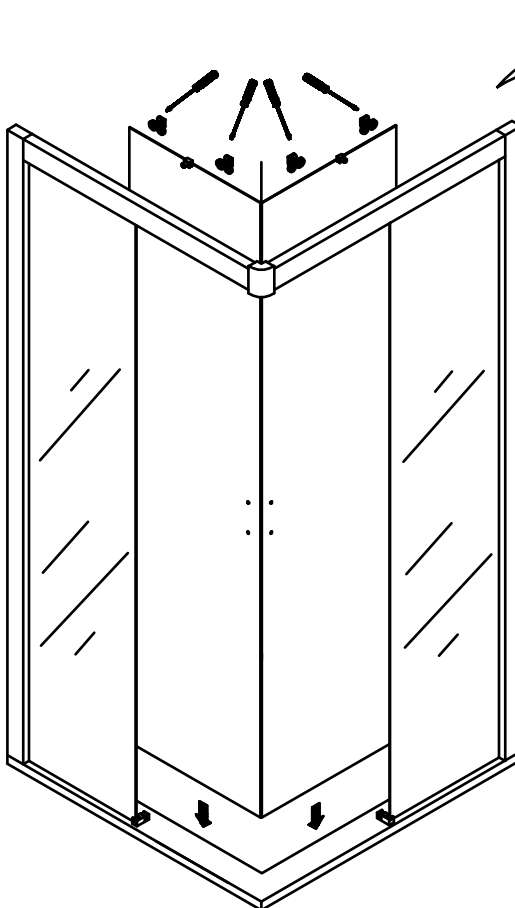
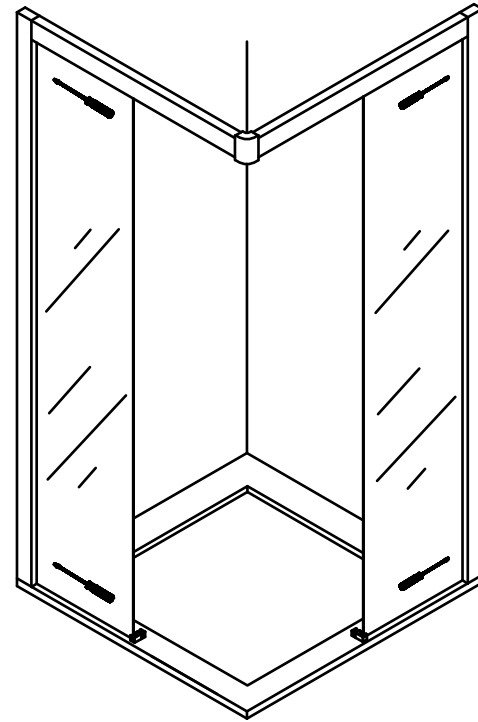
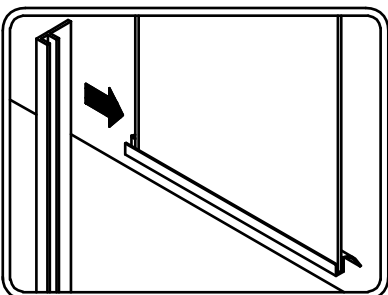
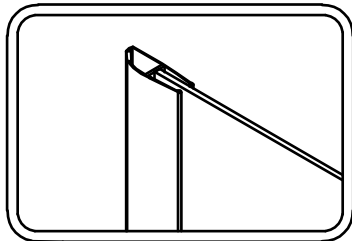

6
 Graduamos la hoja mediante los tornillos de regulación de los rodamientos y colocamos el tirador.

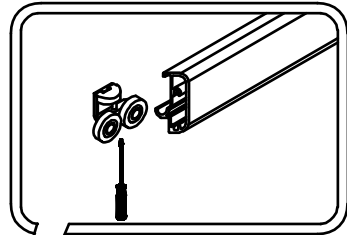
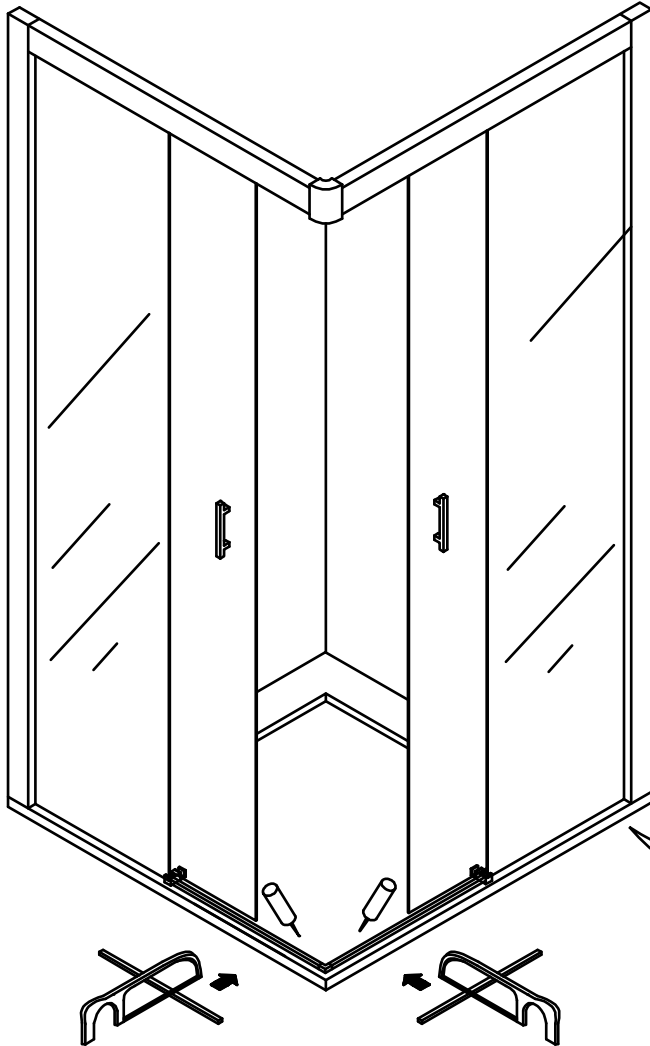

7
 Colocamos embellecedor inferior
 Sellado del contorno de la mampara y colocación de tapas superiores.

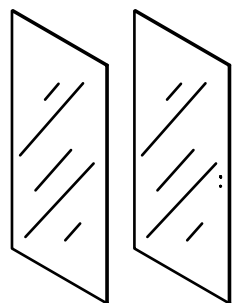
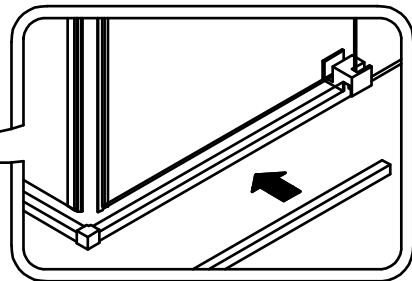
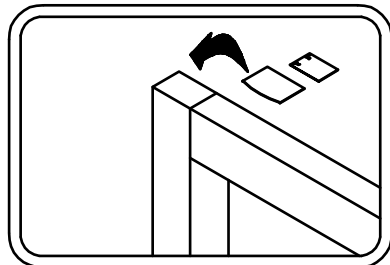

2 x vidrio hoja fija

2 x vidrio hoja corredera



4 x rodamientos de acero inoxidable

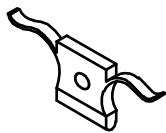

4 x freno

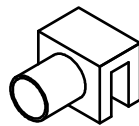

2 x antivuelco

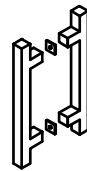

2 x tirador

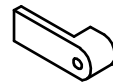

2 x cogidos fijo

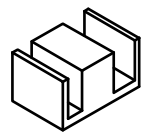

2 x pines guía interior

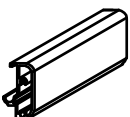

2 x guía superior

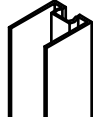

2 x marco lateral

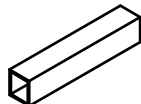

2 x perfil bajo + tapa

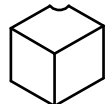

1 x esquina

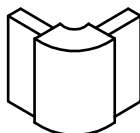

1 x escuadra



2 x goma verteoguas

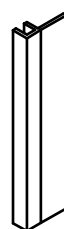

4 x goma cruce



2 x lman cierre



2 x juegos tapas superiores