

**1** Atornillar guía superior e inferior a marco y contramarco previa introducción de los frenos de guía.

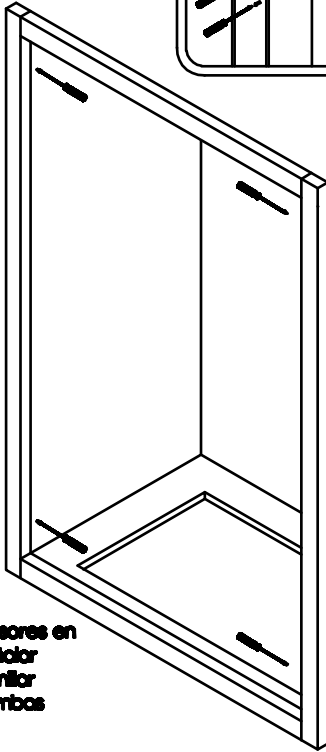

**3** Rellenar con silicona el alojamiento del marco para el fijo, e introducir vidrio fijo.

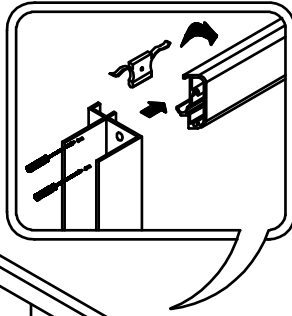
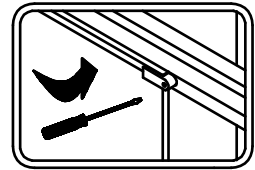
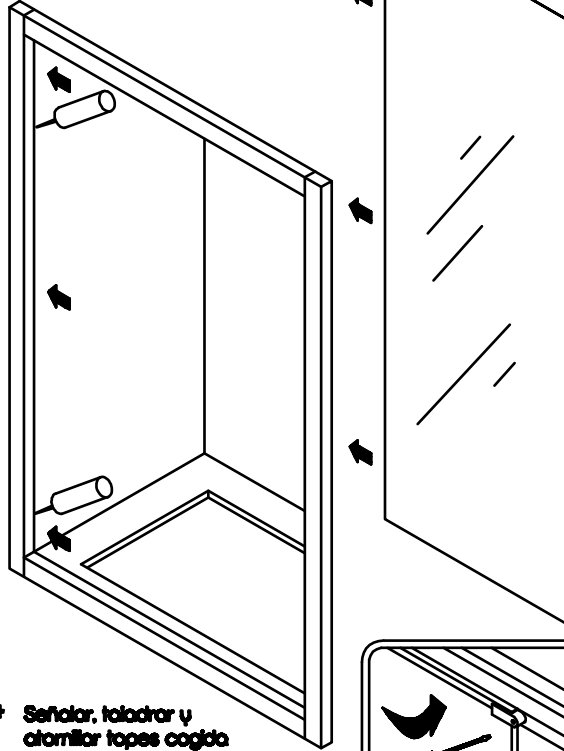

**2** Colocar expansores en los marcos, señalar taladros y atornillar manopla a ambas paredes.

**4** Señalar, taladrar y atornillar topes cogido fijo a guías.

**5** Colocar gomas de cruce e iman de la hoja, posteriormente colocar rodamientos en la parte superior e inferior del vidrio y colgar la hoja.

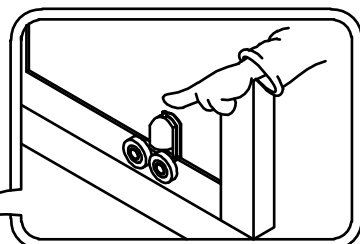
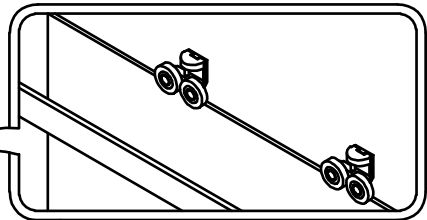
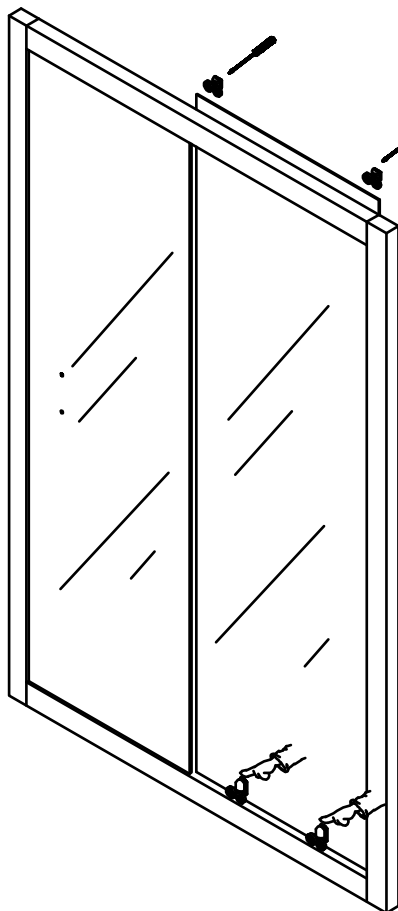
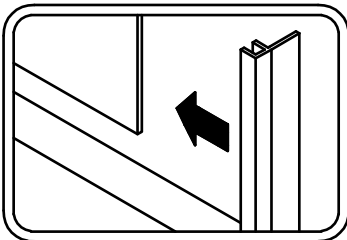
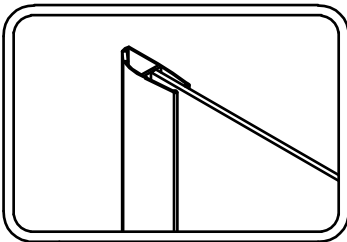

**6**

Graduamos la hoja mediante los tornillos de regulación de los rodamientos y colocamos el tirador.

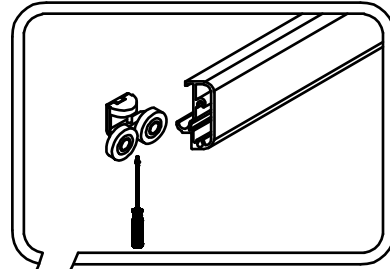
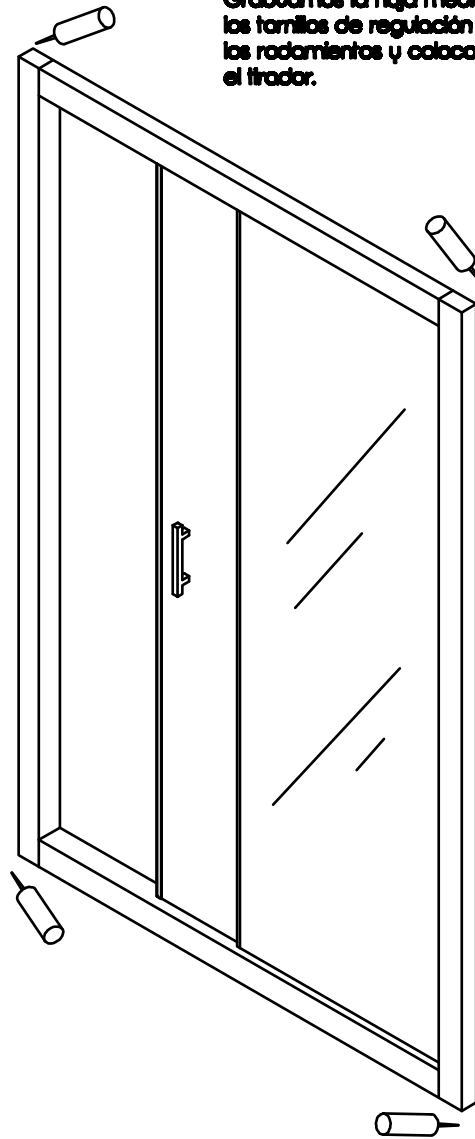

**7**

Sellado del contorno de la mampara y colocación de tapas superiores.

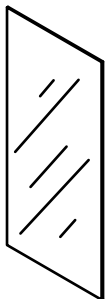
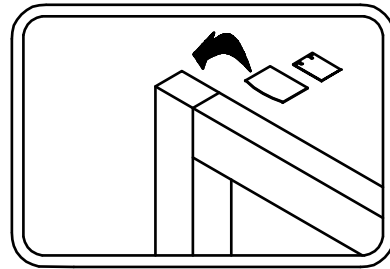

1x vidrio hoja fija

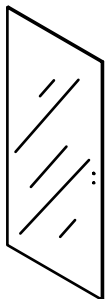

1x vidrio hoja corredera

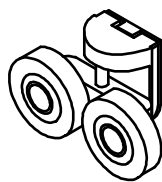

2x rodamientos de acero inoxidable

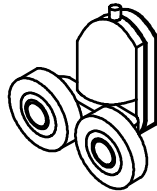

2x rodamientos

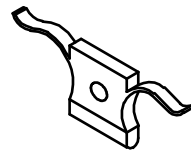

2x freno

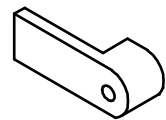

2x cogidos fijo

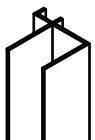

1x contramarco

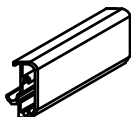

2x guía superior e inferior

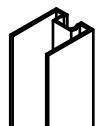

1x marco lateral

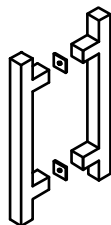

1x tirador

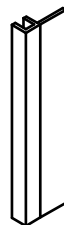

2x gamas cruce

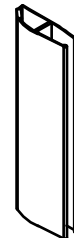

1x imán cierre

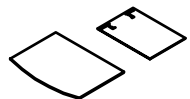

2x juegos tapas superiores