

1
 Presentar "U" en pared y marcar taladros.
 Taladrar con broca de \varnothing 6mm.
 Atornillar la "U" a pared usando tacos del nº6 y tornillos 4,2 x32

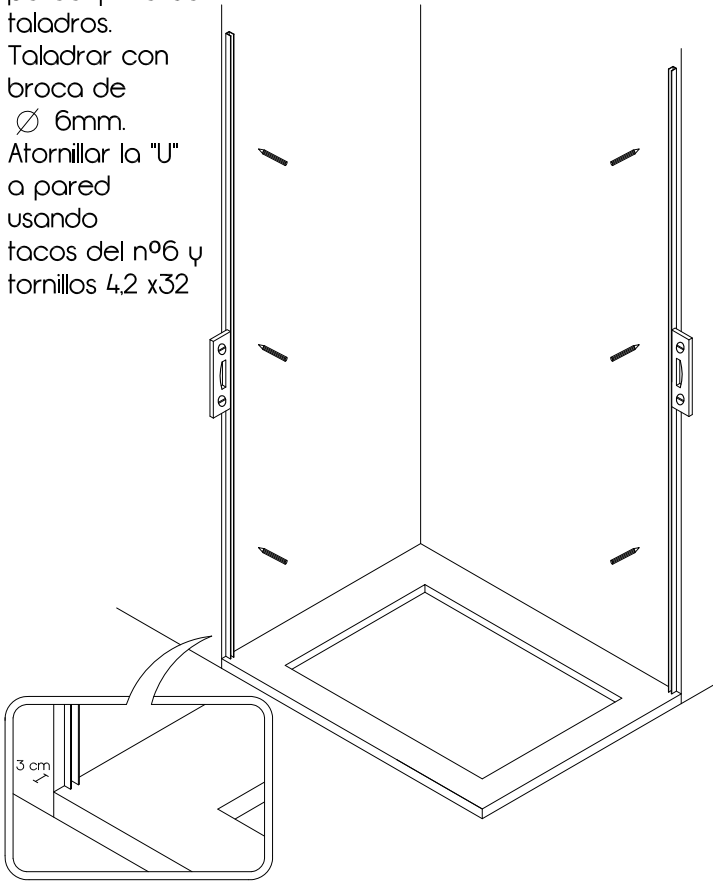

2
 Rellenar con Silicona el interior de la "U".
 Engomar cristal a la "U" y colocar la pinza baja en el extremo del vidrio.

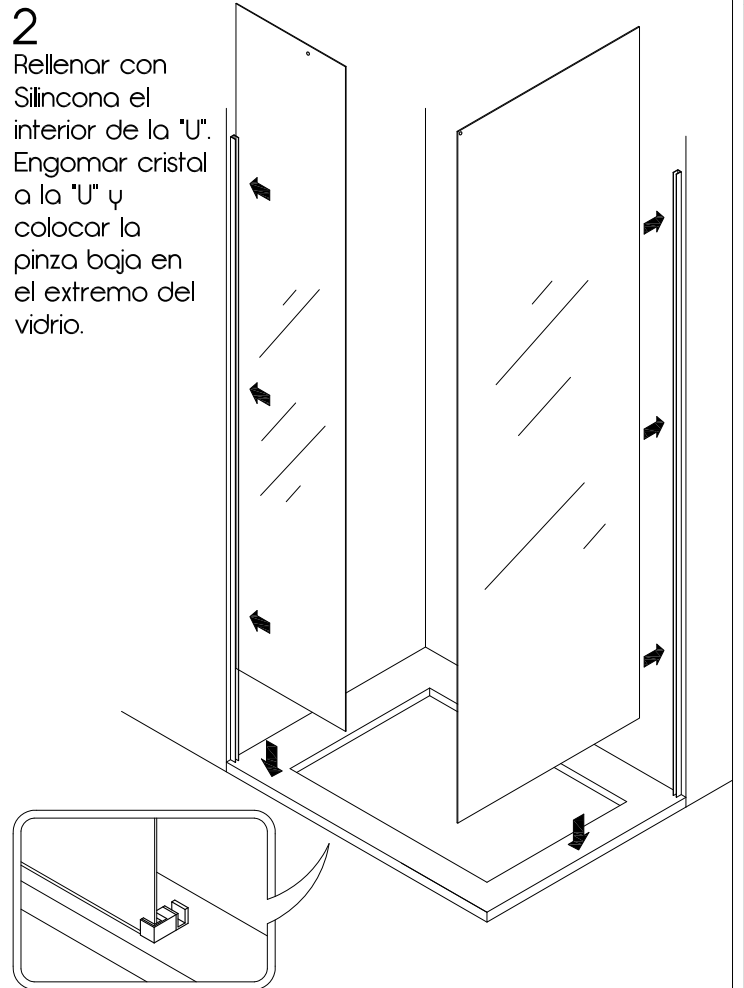

3
 Presentar guía superior sobre el vidrio fijo, para ello ajustar las cogidas, sin apretarlas, nivelar y marcar los taladros y retirar la guía.
 Taladrar con broca de \varnothing 6mm.

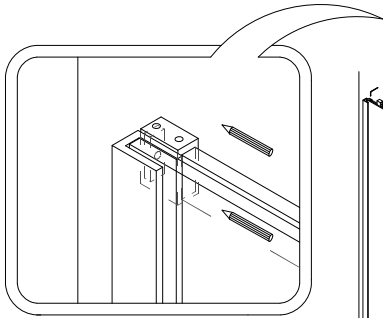

5
 Fijar la cogida al fijo y la guía a las cogidas a pared.
 Colocar la hoja y regular mediante los rodamientos excéntricos.

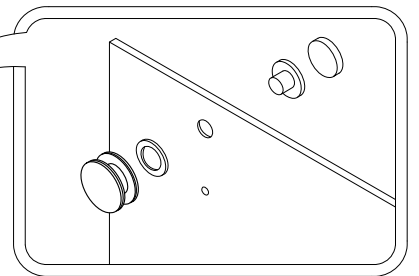

4
 Introducir en la guía el tope y atornillar la guía superior por medio de las cogidas a pared.

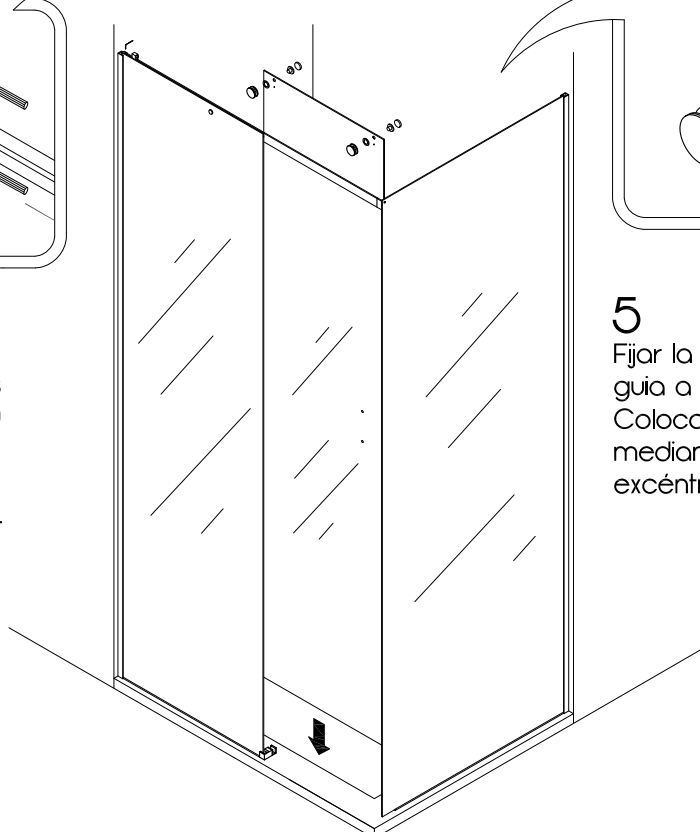
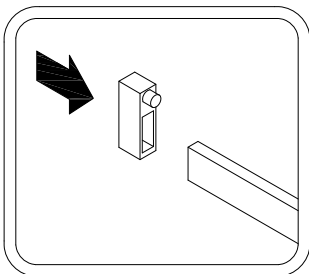

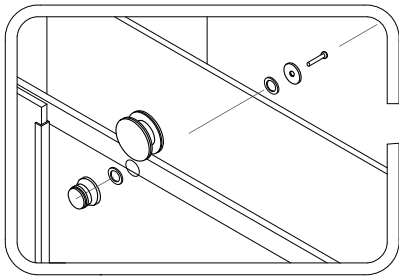

6

Ajustar pernos antivuelco
y colocar tirador

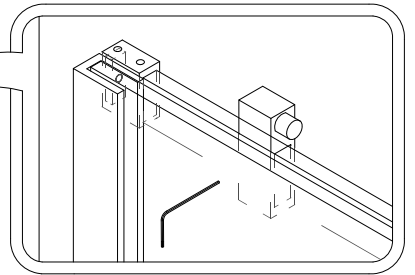
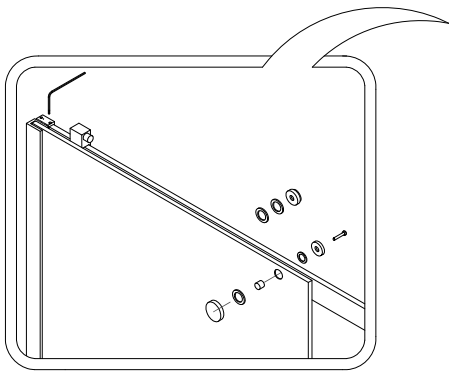

7

Fijar el tope mediante los
prisioneros. Cortar el perfil
a medida, desde la pinza
baja hasta pared y colocar
por delante de la hoja
corredera.
Sellar perfil bajo con silicona,
por fuera y por dentro

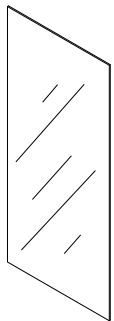

2 x
vidrio hoja fija

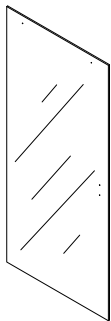

1 x
vidrio hoja
corredera

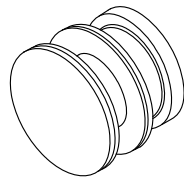

2 x
rodamientos de
acero inoxidable

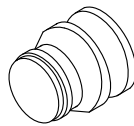

2 x
pernos antivuelco

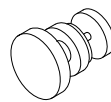

1 x
sujeción fijo/guía

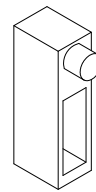

1 x
tope interior guía

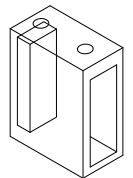

1 x
cogidas a pared/guía

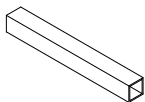

1 x
perfil bajo

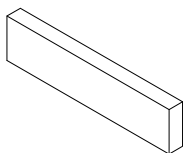

1 x
guía superior

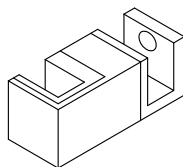

1 x
pinza guía interior

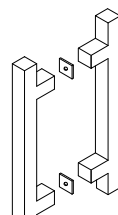

2 x
tirador

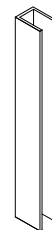

2 x
"U" para fijo



1 x
imán tira
adhesiva

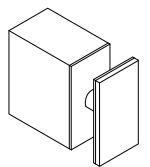

1 x
cogida guía/vidrio
hoja fija