

1
Presentar "U" en pared y marcar taladros. Taladrar con broca de \varnothing 6mm. Atornillar la "U" a pared usando tacos del nº6 y tornillos 4,2 x32

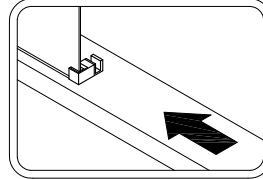

2
Rellenar con Silicona el interior de la "U". Engomar cristal a la "U" y colocar la pinza baja en el extremo del vidrio.

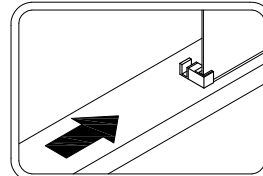
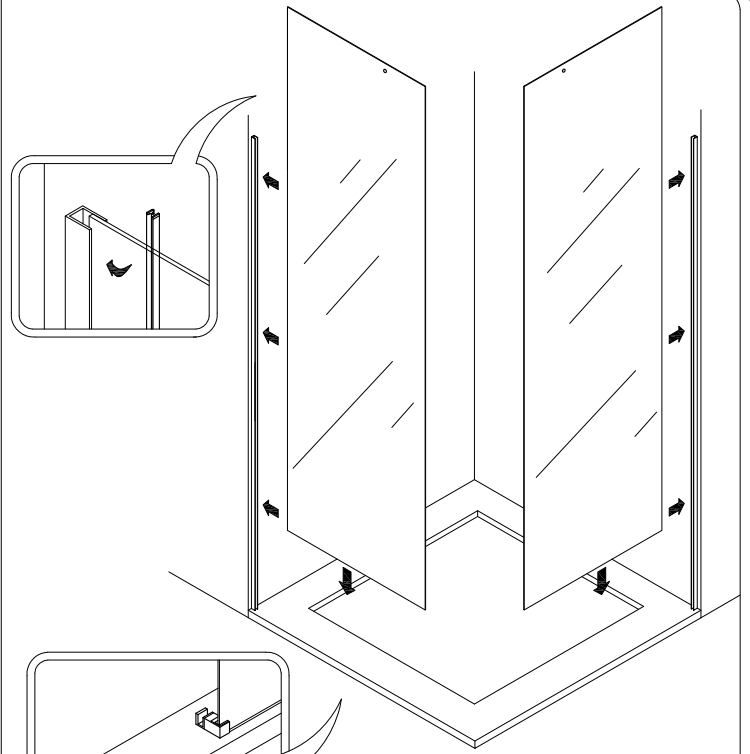
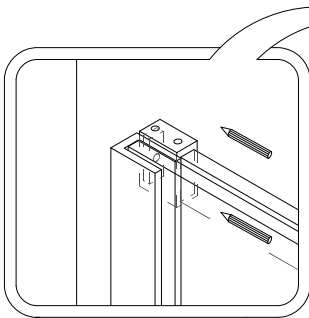

3
Presentar guía superior sobre los vidrios fijos, para ello ajustar las cogidas, sin apretarlas, nivelar y marcar los taladros y retirar la guía. Taladrar con broca de \varnothing 6mm.

4
Introducir en la guías los 4 topes.

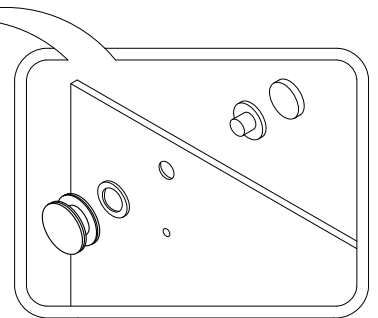
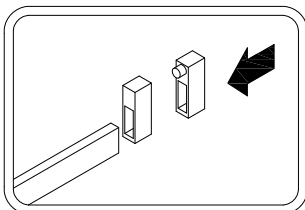
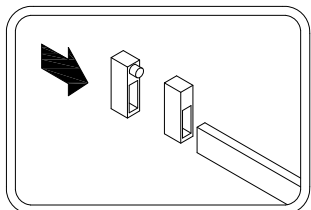

5
Unir las dos guías mediante el codo, fijándolas a través de sus prisioneros.

6
Fijar la cogida al fijo y la guía a las cogidas a pared. Colocar las hojas y regular mediante los rodamientos excéntricos.

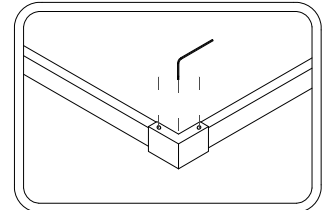
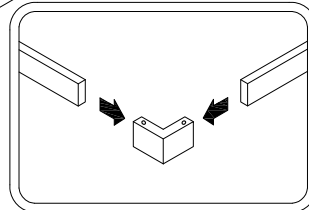

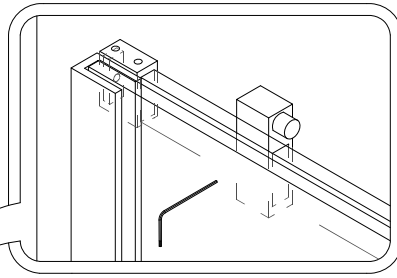
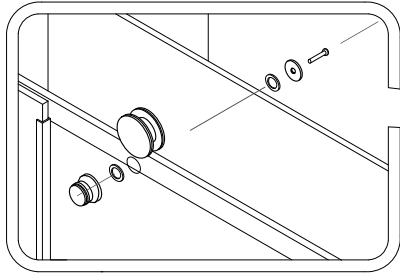

8

Fijar el tope mediante los prisioneros. Cortar el perfil a medida, desde la pinza baja hasta esquinera baja y colocar por delante de la hoja corredera. Sellar perfil bajo con silicona, por fuera y por dentro

7

Ajustar pernos antivuelco y colocar tirador

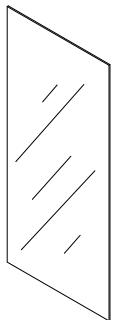
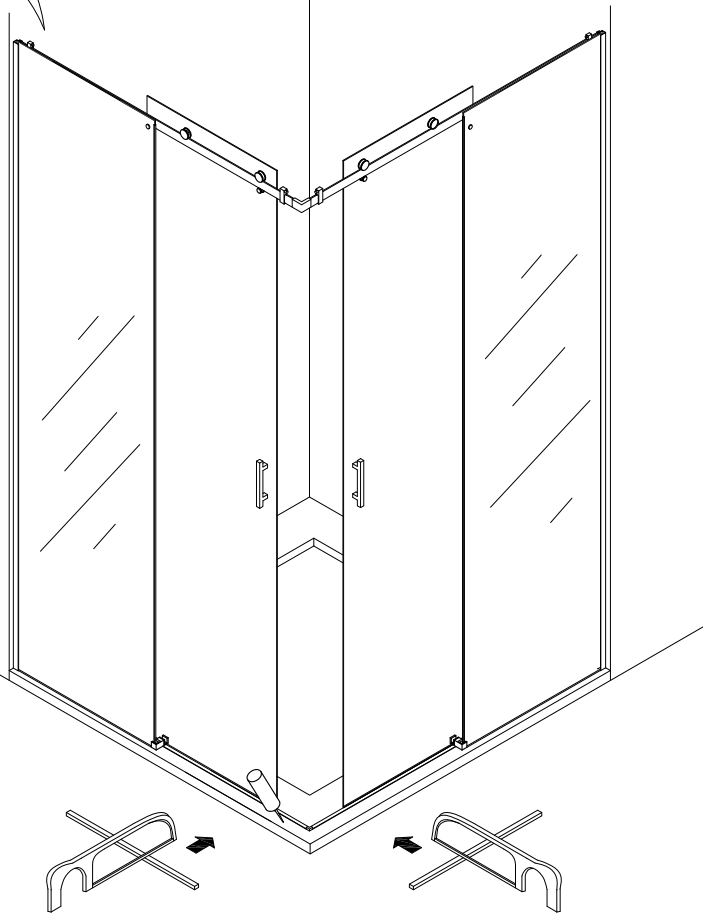
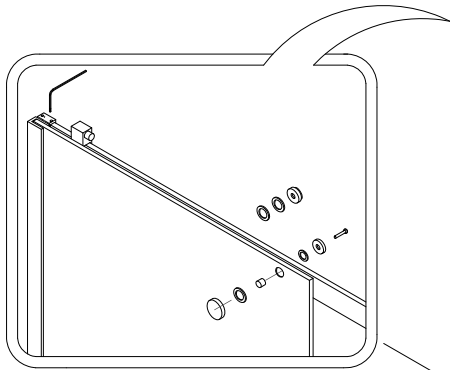

2 x vidrio hoja fija

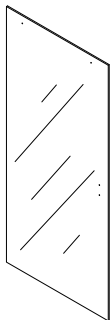

2 x vidrio hoja corredera

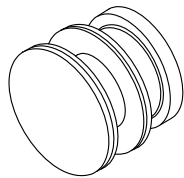

4 x rodamientos de acero inoxidable

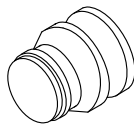

4 x pernos antivuelco

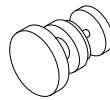

2 x sujeción fijo/guía

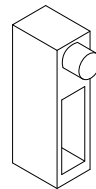

4 x tope interior guía

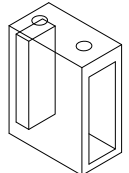

2 x cogidas a pared/guía

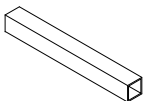

2 x perfil bajo

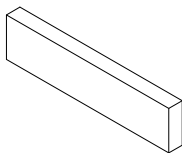

2 x guía superior

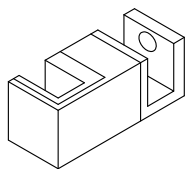

2 x pinza guía interior

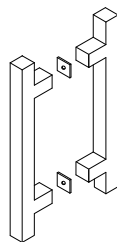

2 x tirador

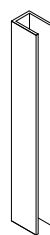

2 x "U" para fijo

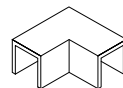

1 x esquinera baja

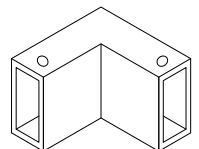

1 x codo unión guía